



1ST CALNE SCOUT GROUP HALL PROJECT



Where we are...

CALNE - WILTSHIRE

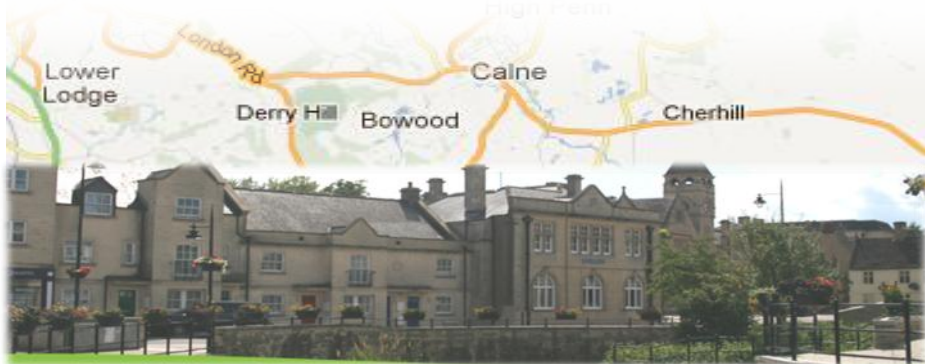

Calne is a thriving market town in Mid Wiltshire with population circa 15,000. In recent years the town has grown substantially, and continues to grow, attracting families with young children into the town.

Calne has a higher proportion of children in its population than Wiltshire's average.

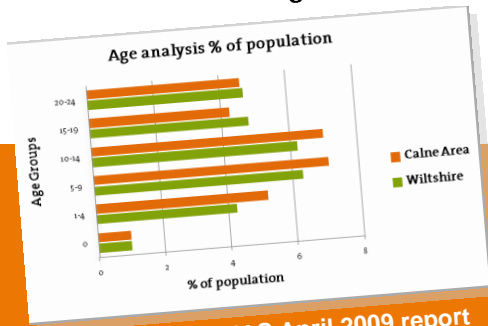

Data from the JNAS April 2009 report

Our children require community activities to give them focus and a place to interact with their peer group in a safe, structured and purposeful setting - 1st Calne Scout Group is one of the solutions.

Calne will continue to see a skew towards a younger population for many years to come, so the need for an **active** and **vibrant** service to the young community is essential.

The Scouts currently provides an outlet for the energies of our children (girls and boys) helping to achieve their potential through “learning by doing”, being given responsibility and working in teams.



We need a bigger hall

1ST CALNE SCOUTS



Our Scout Group, registered 1st February 1912, has been providing youth leadership for the children of Calne for over 100 years.

The current headquarters, was opened in 1962 and over past 50 years the Group has grown from strength to strength.

There's a clear message from our community that accessible fun and adventure for young people is essential.

Scouts continues to be in high demand in Calne, we now support over 100 young people, both girls and boys across Beavers, Cubs, Scouts as well being a base for the Night Hawk Explorers Unit.

Our waiting list for new members wanting to join Scouts is growing. We'd like to **double** the size of 1st Calne Scout Group but we need a **bigger** and **better** hall to make that happen.

Please read on, we'll tell you our plans and how you can help.



This way



Our current hall...



We're very proud of our Hall, and rightly so it's been our home in Calne town centre since 1962.



Back in the late 1940's Boy Scouts started collecting waste paper, and the money received from 145 tons started fundraising for the current Hall.

Times may have changed, but whether we're cooking burgers, packing bags or delivering Christmas post, our girls and boys continue to be actively involved in raising money for running the Group.



...its ripe for improvement.

Our Hall is widely used by the Group as well as the wider community.

As we grow, space is much more important for indoor activities, **storage** of equipment and to run meetings in **parallel** we need a second hall.

Signs of wear and tear are telling but the need for a modernised, safe environment to allow access for all abilities is incredibly important.

This will then allow us to grow the size and capabilities of Scouting in Calne.



JABBA THE HUT

The Night Hawks Explorer Unit was founded in September 2005, in response to the growing needs of the 14-18 year age range, prior to its creation the only option for scouts who wanted to carry on in scouting after the age of 14 was to join an Explorer unit based in Chippenham.

Night Hawks are currently in a converted pre-cast concrete garage building (known as 'Jabba the Hut') at the rear of the main Hall.

Jabba is cramped, damp and a little bit smelly and no longer suitable for their needs. As a temporary measure we have had to change a Scout Troop's meeting time in order to make the Hall available for the Explorers.

What we've got planned...

...a second hall, improved access and layout as well as modernised facilities will give us a better space that allows integration of Beavers, Cubs, Scouts & Explorers within the Calne Scout Centre.

Equipment accessibly stored, makes the Hall a safer place for those energetic games.

The extra hall means more flexible space and more activities at the same time.

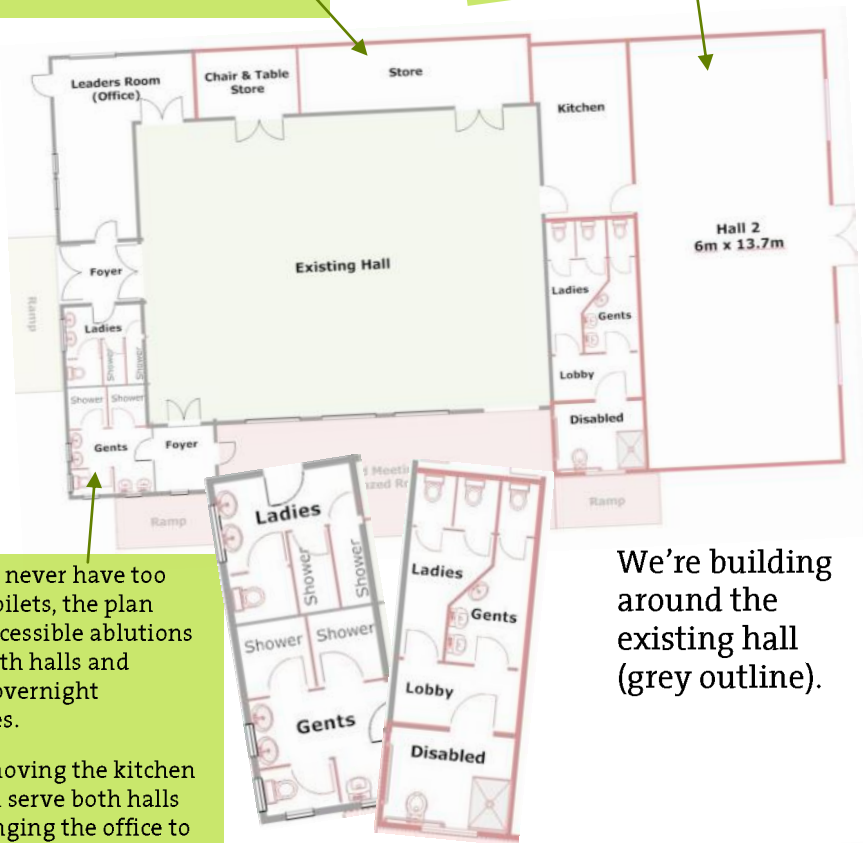

You can never have too many toilets, the plan gives accessible ablutions from both halls and allows overnight activities.

We're moving the kitchen so it can serve both halls and bringing the office to

We're building around the existing hall (grey outline).



For the plans visit www.calnescouts.co.uk/approved_plans

...its great for the community.

This project will have a positive lasting affect upon the Calne Community Area, providing more activities for 6 to 18 year old girls and boys of all ability.

Calne Art, Drama and Yoga groups as well as the town's Silver Brass Band are already our partners taking us over 250 users of the Hall. The intended improvements will allow access to greater numbers of townsfolk for more activities.

With strong environmental credentials our improved Hall will be fantastic for Scouts and great for the community in the centre of Calne.

1st Calne Scouts Environmental Credentials

Why? Sustainability is a Scouting core value.

"Try to leave this world a little better than you found it." Lord Baden-Powell, founder of Scout Movement

Protecting the environment has always been fundamental to the Scouting ethos –



How? Sustainable design is part of the plan

The plans incorporate features which address the following sustainability requirements:



- Minimising energy use
- Saving water
- Reducing car travel
- Generating renewable energy

Minimising energy use by:

- effective insulation
- low-energy under floor heating
- design which maximises natural light through windows and skylights

Before building starts we're encouraging more members of our Group out of their cars and visit the Hall by bike or on foot, before we're bigger, as part of our operating policy.

We need your help...

...to raise £400,000 to extend and modernise. Building will start in 2015.

So far £10,000 has been raised by 1st Calne Scout Group's own fundraising and we're planning many more activities, but we will need your help to meet our target.

You can support 1st Calne Scout Group through...



JustTextGiving

sending SCOU12 £xx to 70070



Search for 1st Calne Scouts

<http://www.btplc.com/mydonate>

as well as contacting our Fundraising Appeal Co-ordinator.

As a trustee or fund manager then please approve our grant application, we assure you it is a great and sustainable investment.

**HELP US
BUILD A
BIGGER HALL...**
Scouting's foundation in Calne

A decorative graphic in the bottom right corner of the page, consisting of a pattern of purple and white bricks arranged in a staggered, overlapping fashion.